

Costa **Toscana.**

Innovation and beauty

Gross tonnage: 186,364 t | **Length:** 337 m | **Width:** 42 m | **Cruising speed:** 17 knots | **Max speed:** 21.5 knots



Interior cabins

Talamone, Montalcino, Bolgheri, Siena, Volterra, San Gimignano, Arezzo, Livorno, Pisa, Lucca, Montecatini Terme

Sea view cabins

Talamone, Montalcino

Sea balcony cabins

Montalcino*, Bolgheri, Siena, Volterra, San Gimignano, Arezzo, Livorno, Pisa, Lucca, Bellagio

Sea terrace cabins

Bolgheri, Siena

Suites

Suite with ocean view balcony.

Bolgheri, Siena, Volterra, San Gimignano, Arezzo, Livorno, Pisa

Grand Suite with ocean view balcony.

Siena, San Gimignano, Arezzo, Montecatini Terme

* Cabins with loggia balcony (the balcony door can be closed by the crew in case of bad weather)

TASTE

• 12 restaurants, two of which, the Archipelago restaurant and the Bellavista restaurant, requiring payment and by reservation • 15 bars including the first Kartell Cafè on a cruise ship, two Aperol Spritz Bars, the stylish Campari Bar, the Bar Sport and the Caffè Vergnano 1882 • 9 Food Outlets including the first Ferrari Spazio Bollicine food outlet on a cruise ship, Pizzeria Pummid'Oro, Heineken Star Club and Bistro, LAB Restaurant, Sushino at Costa, Teppanyaki, Street Food Restaurant, Kikipoke, Nutella at Costa, 2 Gelateria-Cioccolateria Amarillo, requiring payment.

WELLNESS AND SPORT

• Solemio Wellness Center, inspired by the sun and colors of the Amalfi Coast has the largest wellness center in our fleet with a thalassotherapy pool, sauna, hammam, 16 treatment rooms, snow room, salt and relaxation rooms, beauty salon and barber corner • an exclusive gym • spinning room • TRX equipment and yoga room • multisport field • water park • 4 pools including one covered and a reserved deck pool.

ENTERTAINMENT

• The Colosseo: the beating heart of the ship, it's a theater on 3 decks dedicated to the best shows and with the best lounge bars • Piazza del Campo, an open-air entertainment area with ship's wake view • the "Volare" Promenade which reaches the highest point of the ship at a height of 65 meters • a water park with slides • a Poltrona Frau Arena theater at the bow • the casino • the Club games room • the area dedicated to kids and young people, a mini club for children aged 0-3, requiring payment.

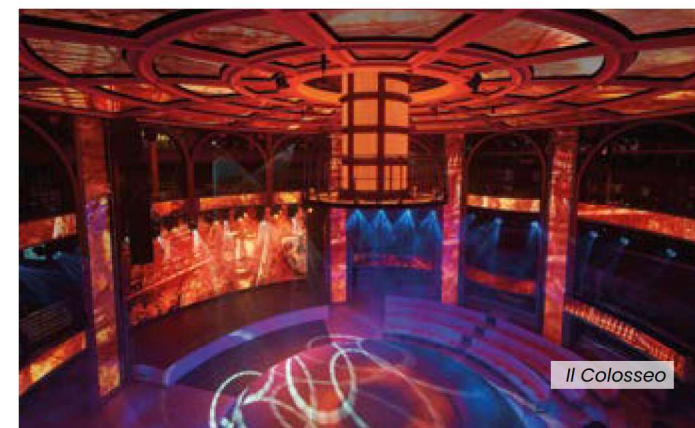

NB: double beds are available in all categories of cabin.
 3rd and 4th beds are available in all categories.

- H cabins for people with disabilities
- C connecting cabins
- E lift
- single sofa bed
- 1 high bed

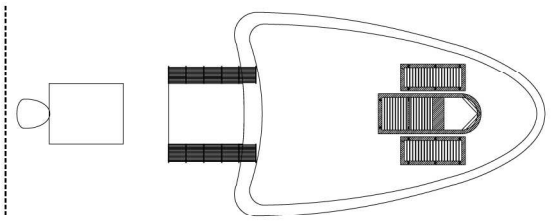

DECK 20 - FORTE DEI MARMÌ

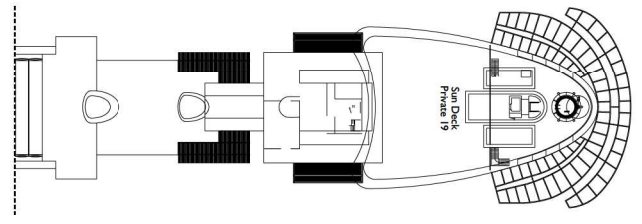

DECK 19 - PIETRASANTA

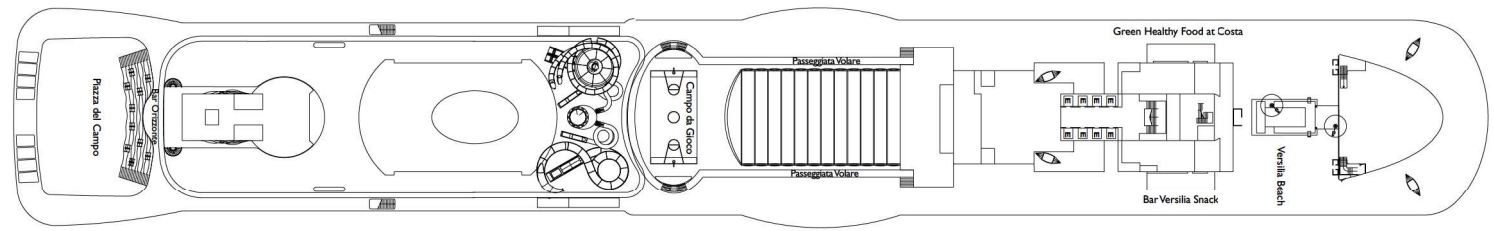

DECK 18 - VIAREGGIO

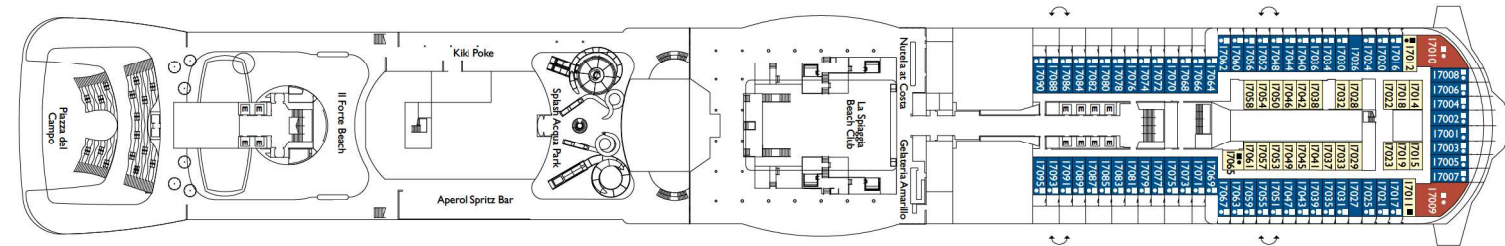

DECK 17 - MONTECATINI TERME

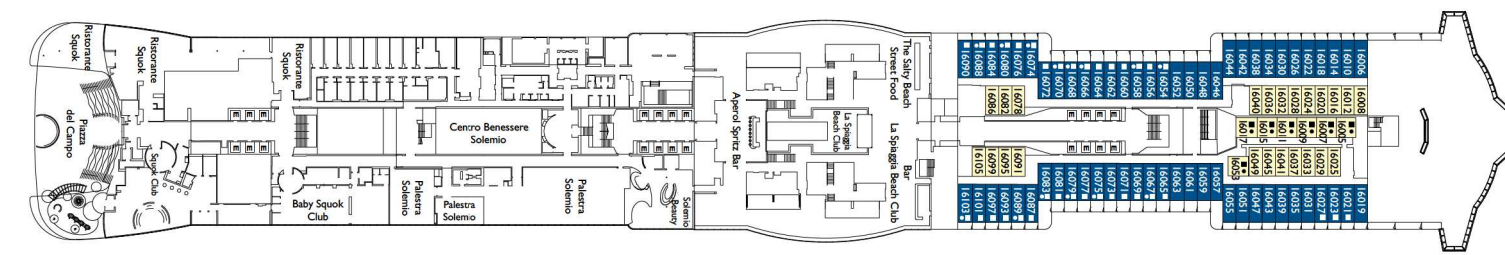

DECK 16 - LUCCA

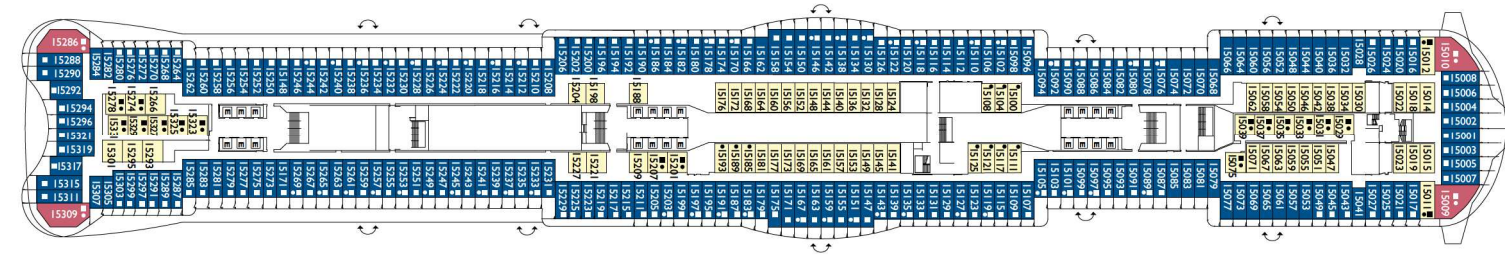

DECK 15 - PISA

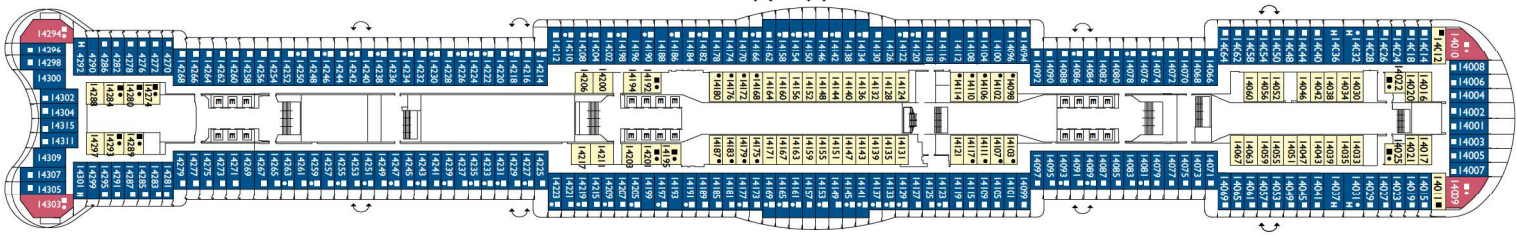

DECK 14 - LIVORNO

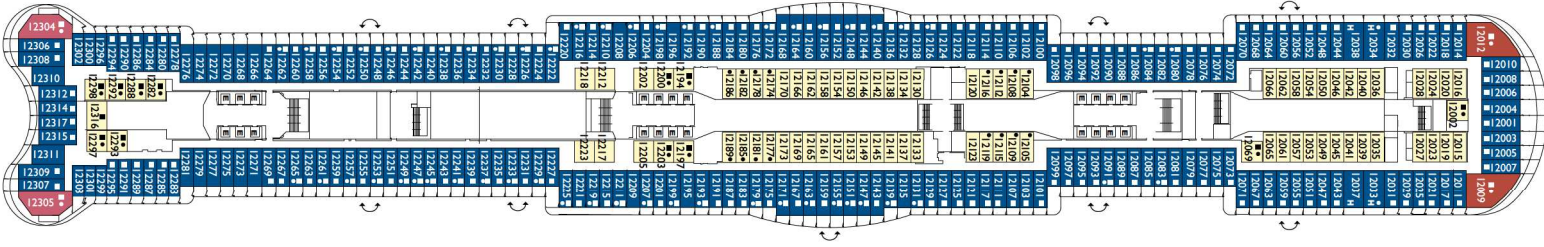

DECK 12 - AREZZO

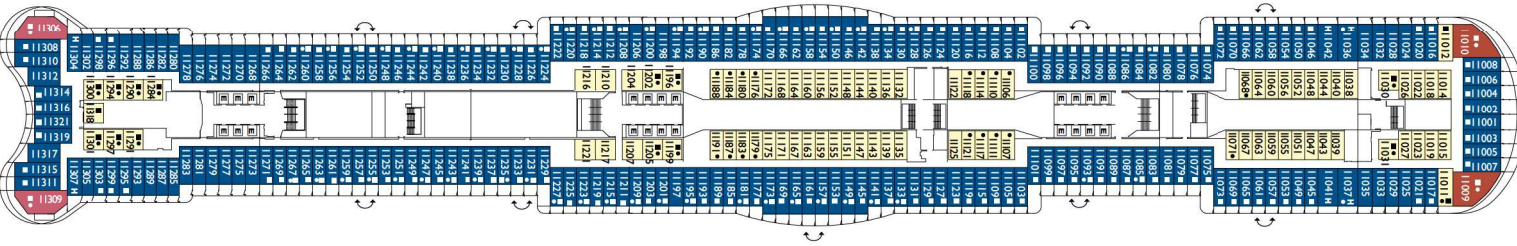

DECK 11 - SAN GIMIGNANO

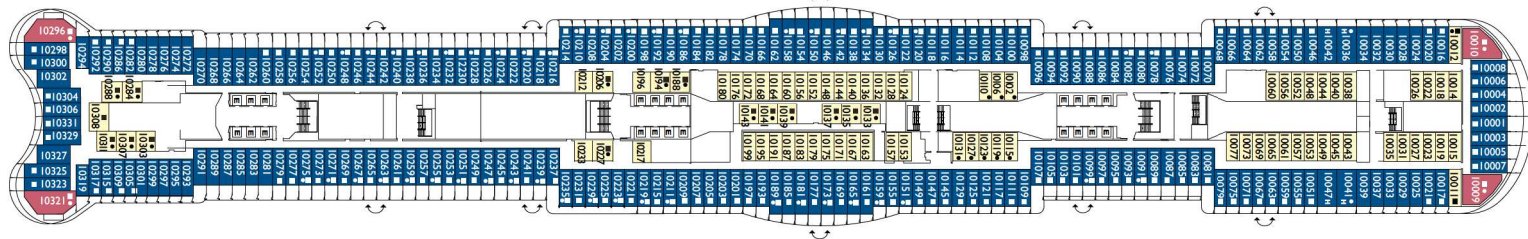

DECK 10 - VOLTERRA

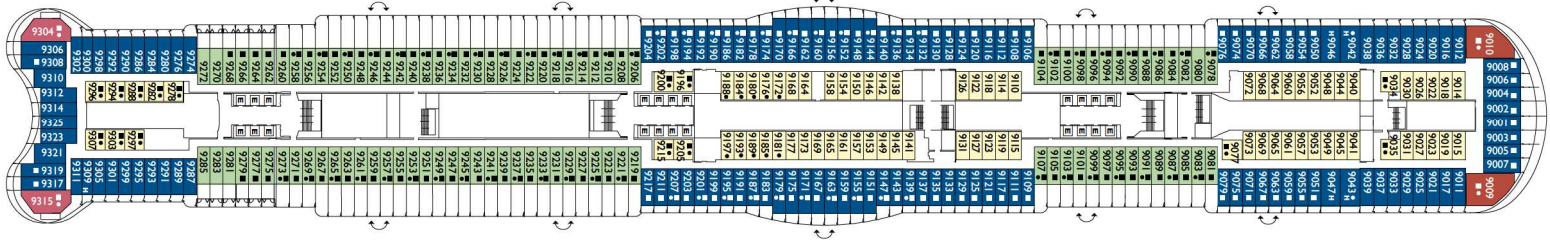

DECK 9 - SIENA

